

EU

Smart Plug

Balcony Energy Storage Solutions

User manual

Disclaimer

Before using this product, please carefully read this user manual to ensure that you have a full understanding of the product and know how to use it correctly. After reading this user manual, please keep it properly for future reference.

Incorrect use of this product may cause serious injury to yourself or others, or result in product damage and property loss. Once you use this product, it is deemed that you understand, acknowledge, and accept all the terms and contents in this document. The company is not responsible for any loss caused by users not following the guidelines in this user manual.

Within the bounds of laws and regulations, the final interpretation of this document and all related materials concerning this product belongs to the company. Changes to this document (updates, revisions, or termination) may occur without prior notice. For more product warranty information, please contact your local distributor or visit the company's official website for the latest product information. The website address: <https://www.topbandsolar.com>.



Use indoor only.



SHENZHEN TOPBAND CO., LTD. declares that Smart Plug is in compliance with Directive 2014/53/EU.



The crossed-out wheeled bin indicates that the electrical and electronic (EE) product should not be discarded as unsorted waste but must be sent to separate collection facilities for recovery and recycling.

CONTENS

- 1. Safety Instruction**
 - 1.1 General safety..... 4
 - 1.2 Product Overview 4
 - 1.3 LED Indicator..... 4
- 2. How to link app**
 - 2.1 APP Download 5
 - 2.2 Install smart plug..... 5
 - 2.3 APP links to smart plug..... 6
- 3. Technical datasheet**
 - 3.1 Model: EPlug25..... 8

1. Safety Instruction

1.1 General safety

1. Before using this product, carefully read and understand this document and all related materials. Improper use may result in serious injury or property damage.
2. Ensure the connected device' s input rating does not exceed the rated capacity of this product.
3. Plug this device into an easily accessible grounded outlet.
4. Do not connect two or more of these devices in series.
5. Do not attempt repairs yourself. For cleaning, use a dry cloth.

1.2 Product Overview

The smart plug connects to a standard household socket to monitor the energy consumption of devices plugged into it and enables remote switch control.

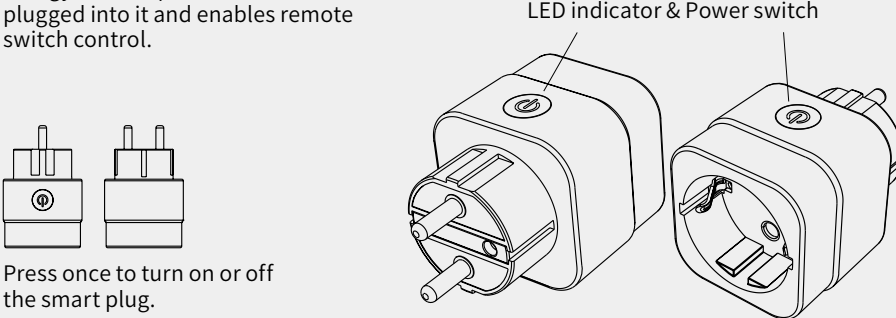

Press once to turn on or off the smart plug.

1.3 LED Indicator

Colour	Status	Description
Blue	Bliking	Wi-Fi not connected
Blue	Solid	Wi-Fi connected
Pink	Solid	Smart plug open.
Extinguish	Extinguish	Smart plug off
Red	Bliking	Breakdown

2. How to link app

2.1 APP Download

① NOTICE

1. To ensure proper device operation, please use the app to configure device settings after powering on.
2. The images are for reference only; please refer to the actual application interface.

• Remotely control, monitor, and customize your device through the app.

The Ecosolex P1 app is a mobile application that communicates with the device via Bluetooth, Wi-Fi, or GPRS modules. You can download it from Google Play or the App Store.

Key features include:

1. View device operating data, software version, and alarm information.
2. Configure grid parameters and communication settings for the device.
3. Perform device maintenance.
4. Update the device's software version.

Privacy Policy: By using our products, app, and services, you agree to TOPBAND' s Terms of Use and Privacy Policy, accessible through the "About" section on the "User" page within the app.

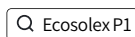

2.2 Install smart plug

1. Plug in the smart plug.
Turn on the smart plug' s power switch.

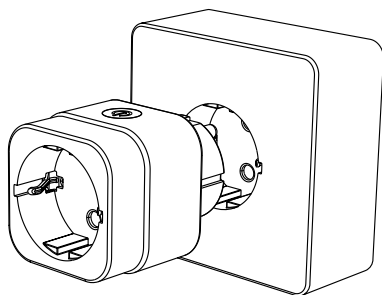

2. The indicator light is flashing blue.
Connect to the app following the instructions below.

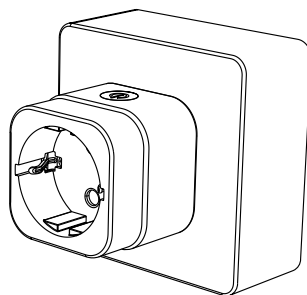

2.3 APP links to smart plug

Add smart plug:

1. Select “More” .
2. Select “Add accessories” .
Ensure the smart plug is powered
and the switch is turned on.
3. APP searches accessories.

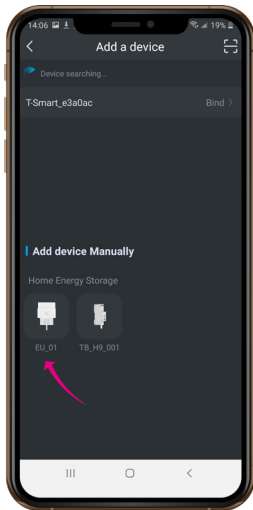
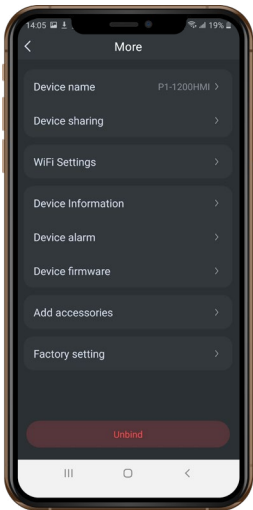

4. APP connect with the plug
via Bluetooth.
5. Networking plug, ensure the
inverter is to be connected to
the same router as the plug.
6. After successful network
connection, the home page will
appear “Socket” .

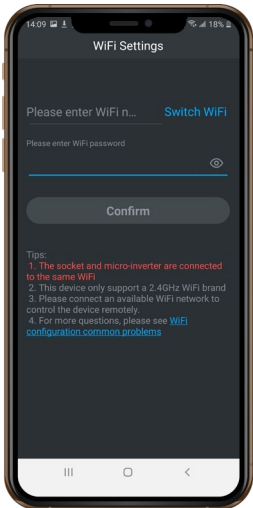
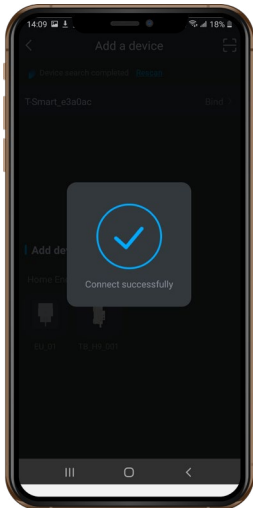

2.3 APP links to smart plug

7. “Socket” device list.
The blue switch button can turn the smart plug on or off.
8. Plug information page.
Delay off: turning off the countdown;
Timing: timed switching the plug.
9. Light switch is to turn on and off the led light on the socket; Power Reset is to reset the smart plug statistics.

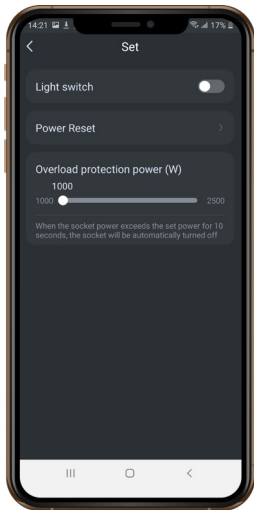
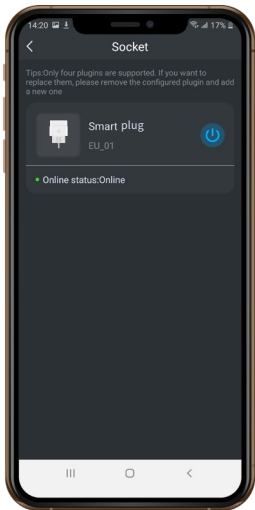

3. Technical datasheet

	Model	EPlug25
Data	Voltage	100V-250Vac
	Alternating current	10A
	Frequency	50Hz
	Minimum displayed power	1W
	Overvoltage category	II
Smart control	Measure	Voltage, current, power.
	APP Control	Support
	Connection	APP connection and QR code scanning connection.
On/Off		APP control on/off (relay).
	On/Off	Regular on and off.
		Push-button on-off.
Wi-Fi (2.4 g)	Wi-Fi	IEEE802.11b/g/n+BLE4.2
	Frequency range	20M:2412-2472 MHz/ 40M:2422-2462 MHz
	Maximum output power	≤20 dBm
Bluetooth	Bluetooth	IEEE802.11b/g/n+BLE4.2
	Frequency range	2402-2480MHz
	Maximum output power	≤20 dBm
Pilot lamp		Blue flashing: Wi-Fi not connected
		Blue: Wi-Fi connected
	Status indicator lamp	Pink: Socket turned on
		Fault: Red flashing
		Off: Socket turned off
Others	Pollution degree	2
	Altitude	≤2000m
	Humidity	-20°C-45°C
	Operating temperature	10%-90%RH
	Product color	White
	Dimensions (LxWxH)	55x55x79mm
	Weight	95g
	Warranty	5 Years



www.topbandsolar.com



SHENZHEN TOPBAND CO., LTD.

Stock code: SZ002139

Tel: +86-755-2765 1888-2658 · E-mail: powersystem@topband.com · Web: www.topbandsolar.com
Add: Topband Industrial Park, LiYuan Industrial Zone, ShiYan Town, Bao'an District, Shenzhen, China.